

SCHEDULE OF JOINERY

D	DOOR	3' 3" x 7' 0"	H.P.
D ₁	DOOR	3' 0" x 7' 0"	
D ₂	DOOR	3' 0" x 7' 0"	
W	WINDOW	5' 0" x 4' 6"	
W ₁	WINDOW	4' 0" x 4' 6"	
V	VENTILATOR	3' 0" x 2' 0"	

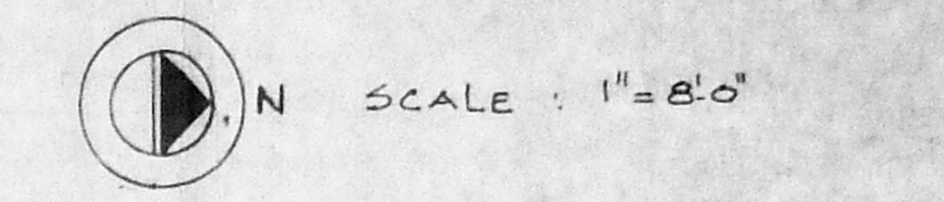

AREA STATEMENT

PLOT AREA	: 2652 SFT	(a) 246.37m ²
GROUND FLOOR	: 1527	" 141.86m ²
FIRST FLOOR	: 1549	" 143.90m ²
SECOND FLOOR	: 1549	" 143.90m ²
TOTAL	: 4625	" 429.66m ²

COLOUR INDEX

PROPOSED WORK	▬
ROADS	▬
BOUNDARY	▬

PLAN SHOWING THE PROPOSED BUILDING AT DOOR No. 150 VENKATA-RANGAM PILLAI ST., R.S.No. 17111 BLOCK No. 34, (OF TRIPPLICANE MADRAS-5.

- OWNER**
- Z. Thiruvengadam
 - T.A. Bhooma Jagannathan
 - Kamala Subbagan
 - T. Thiruvengadam
 - J. Ramarajam
 - V. Narasimhan
 - M. Chandrasekhar

ARCHITECT S. ANANTHACHARI, F.I.R.A., M.I.S.E., Registered Architect & Engineer No: CA. 75/94, Class-I Licensed Surveyor No. R.A. 25, CORPORATION OF MADRAS, 681/2, ANNAMALAI STREET, TRIPPLICANE, MADRAS-600 005.

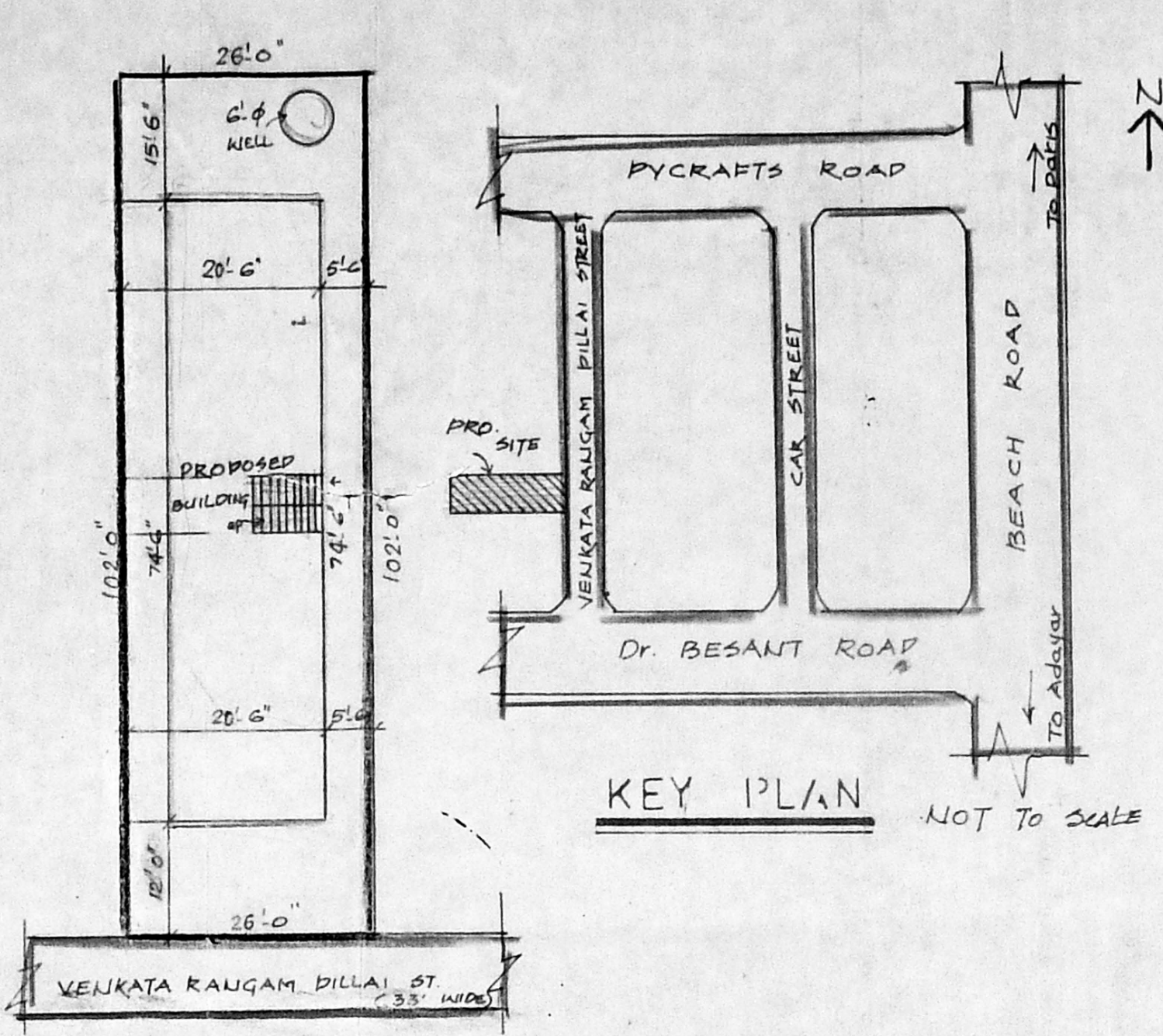
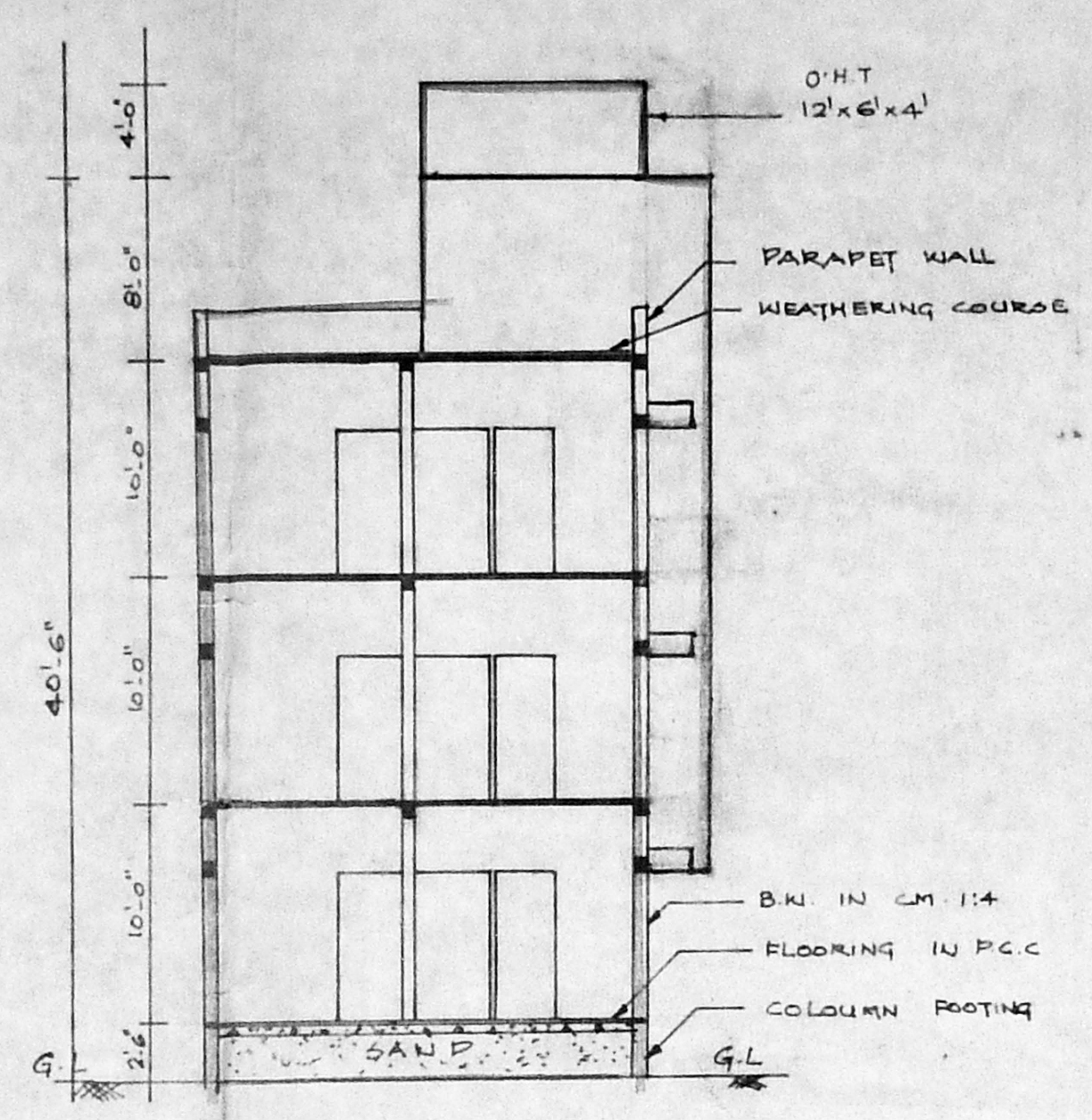
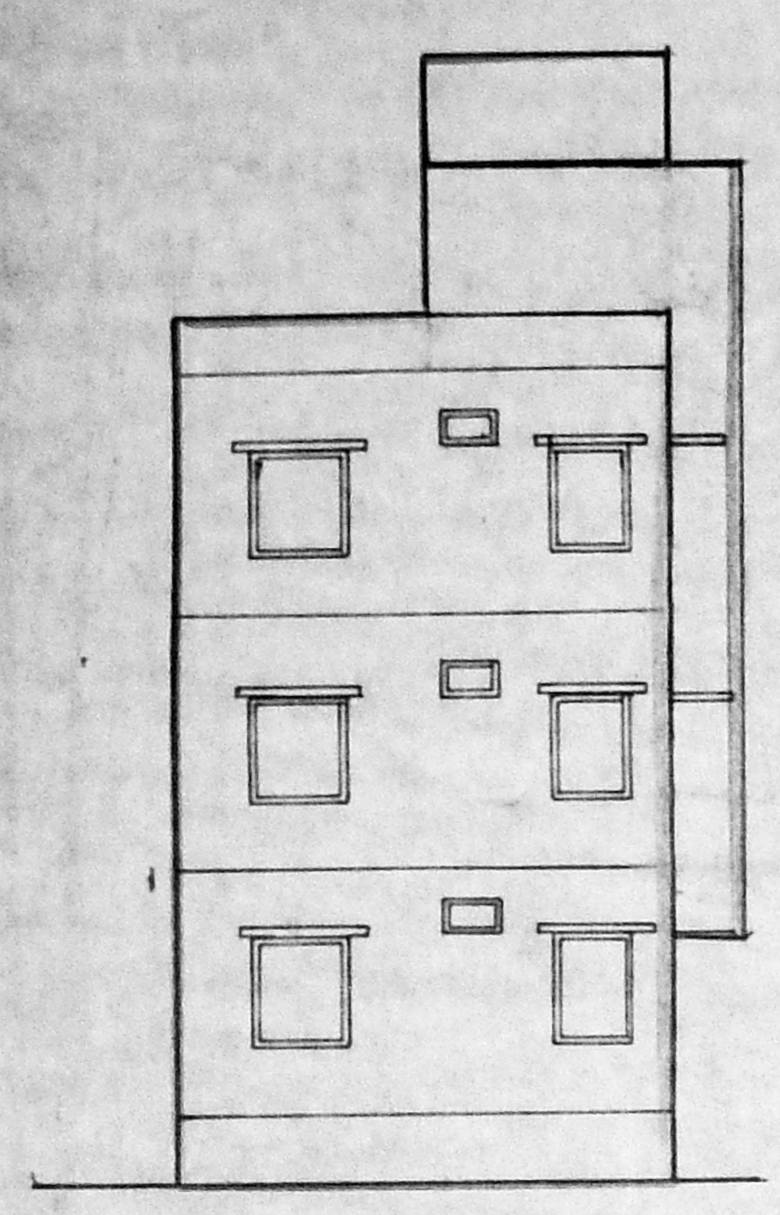

SITE PLAN SCALE 1" = 16' 0"

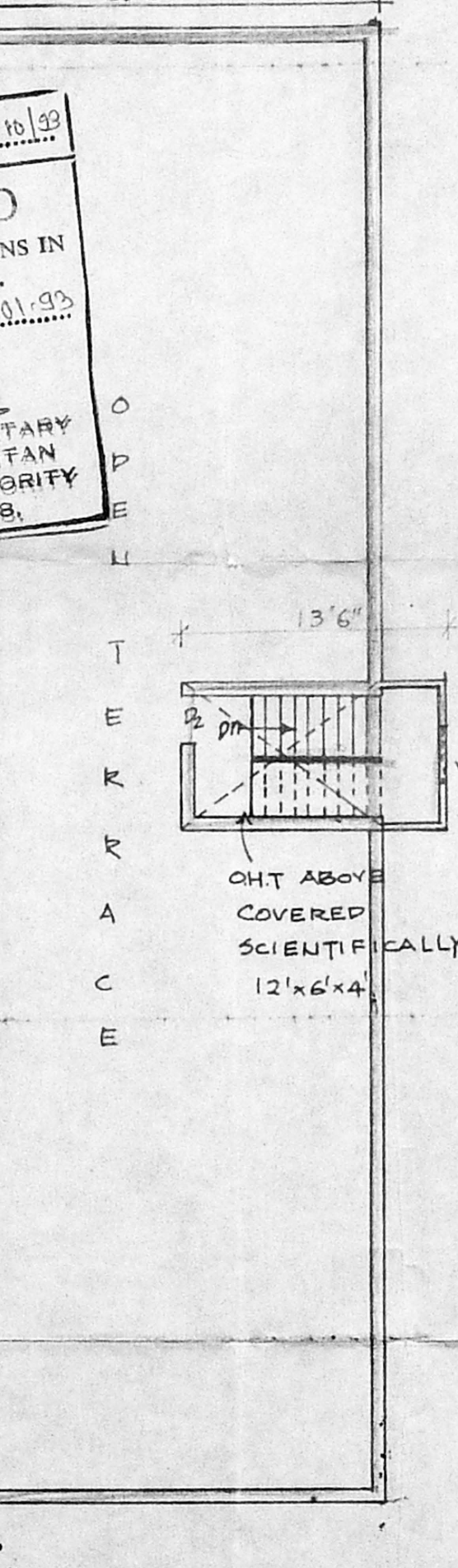
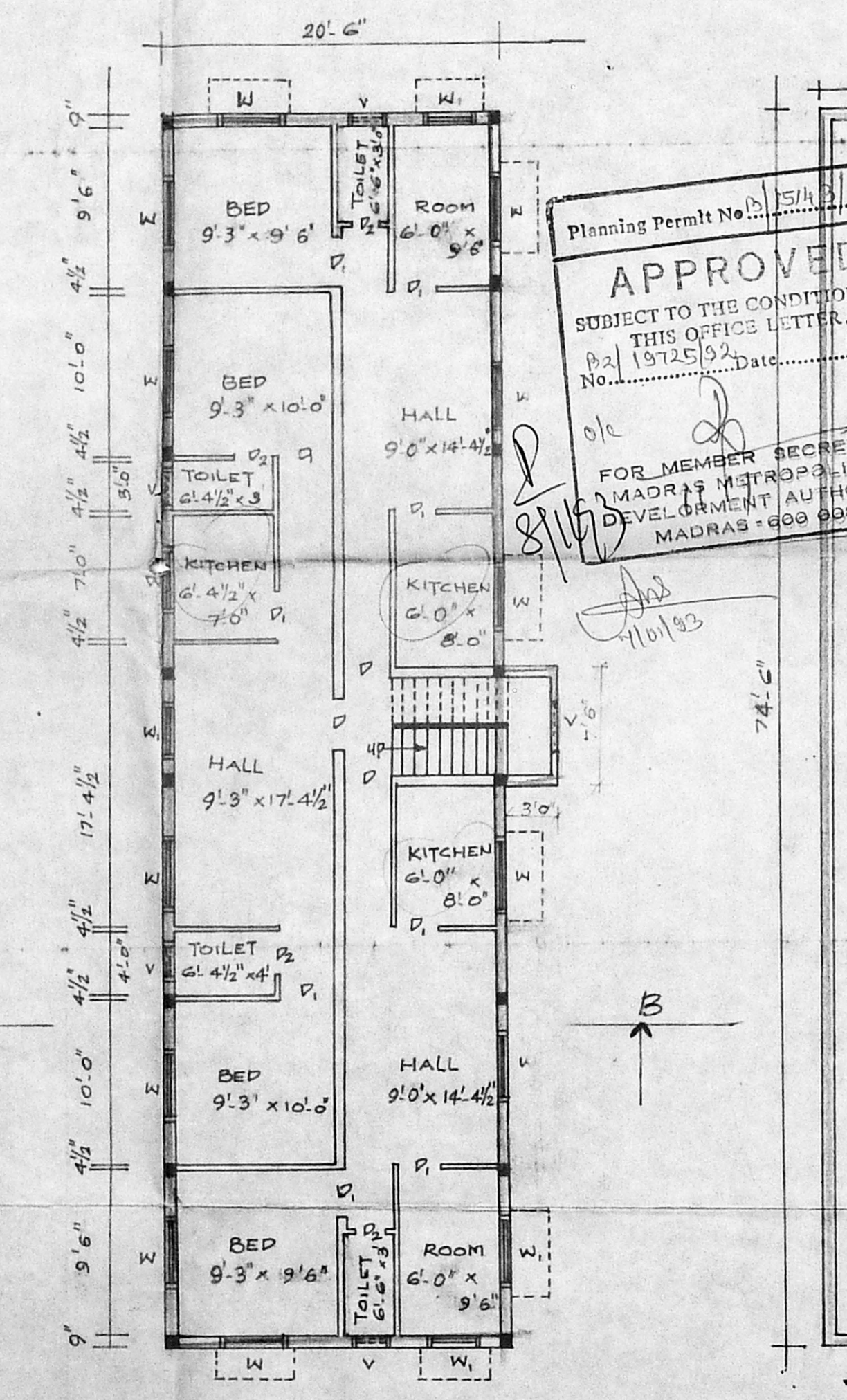
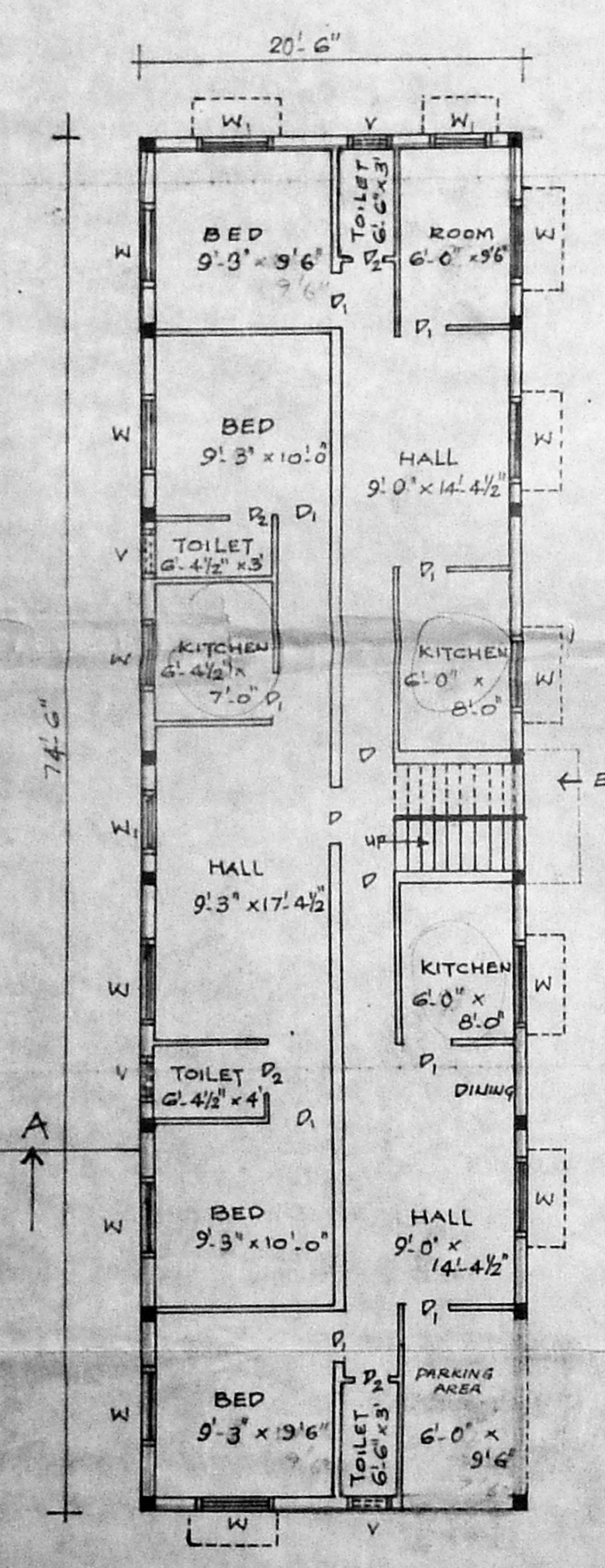

Planning Permit No. 15/11/10/99
APPROVED
SUBJECT TO THE CONDITIONS IN THIS OFFICE LETTER.
P2/19725/92 Date: 11.9.93
FOR MEMBER SECRETARY
MADRAS METROPOLITAN
DEVELOPMENT AUTHORITY
MADRAS-600 088.

